

EMD F7

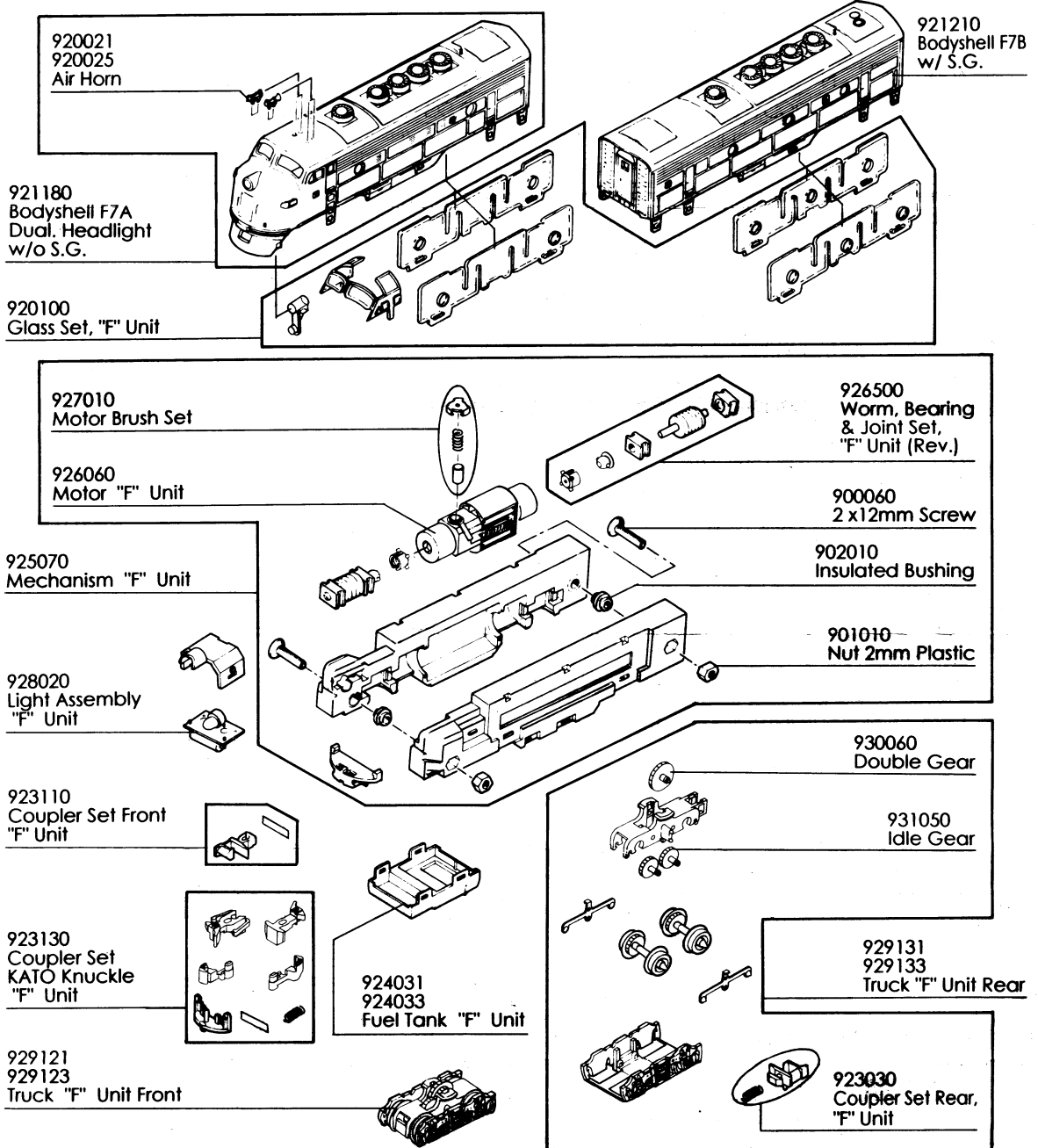

* Part colors vary by roadname.

(Certain parts may not be available separately, please refer to Parts Listing on Back for specific details.)

NOTICE:	LIMITED WARRANTY
<p>1. Max.Operational voltage: 12V DC</p> <p>2. Additional lubrication at time of purchase is not recommended.</p>	<p>KATO U.S.A. INC. warrants that this product will be free from defects in material and workmanship for a period of sixty (60) days from the date of purchase. If this product fails during the warranty period, carefully pack the assembled item in the original carton, together with the dated sales receipt, and return to: KATO U.S.A. INC. 100 Remington Road, Schaumburg, IL 60173. Defects due to misuse, improper maintenance and/or abuse are not covered by this warranty. Items that have been modified by the modeler or anyone other than an authorized KATO repair person are not covered by the warranty. This warranty gives you specific legal rights and you may also have other rights which vary from state to state.</p>

Parts Price List & Order Form

Item Number	Description	Retail Price
900060	A SCREW 2 X 12mm ROUNDHEAD (6EA)	\$1.00
901010	A HEX NUT 2mm PLASTIC (6EA)	\$1.00
902010	A INSULATING BUSHING 2mm PLASTIC (6EA)	\$1.00
920021	N AIR HORN 1 CHIME BLACK (2EA)	\$1.00
920025	N AIR HORN 1 CHIME RED (2EA)	\$1.00
920100	N GLASS SET F UNIT (EA)	\$4.00
921180	N BODYSHELL F7A DUAL HL W/O SG UNDEC (EA)	\$25.00
921210	N BODYSHELL F7B W/ SG UNDEC (EA)	\$25.00
923030	N COUPLER SET RAPIDO F UNIT REAR (SET)	\$1.00
923110	N COUPLER SET RAPIDO F UNIT FRONT (SET)	\$1.00
923130	N COUPLER SET KATO KNUCKLE F UNIT (SET)	\$2.00
924031	N FUEL TANK F UNIT BLACK (EA)	\$1.50
924033	N FUEL TANK F UNIT SILVER (EA)	\$1.50
925070	N MECHANISM F UNIT COMPLETE REV W/O TRUCKS (EA)	\$40.00
926060	N MOTOR F UNIT REV (EA)	\$25.50
926500	N WORM, BEARING & JOINT SET F UNIT REV (2EA)	\$4.00
927010	N BRUSH SET (CAP, SPRING & BRUSH) (2EA)	\$2.00
928020	N LED LIGHT F UNIT (EA)	\$5.50
929121	N TRUCK ASSEMBLY F UNIT FRONT BLACK REV (EA)	\$10.00
929123	N TRUCK ASSEMBLY F UNIT FRONT SILVER REV (EA)	\$10.00
929131	N TRUCK ASSEMBLY F UNIT REAR BLACK REV (EA)	\$10.00
929133	N TRUCK ASSEMBLY F UNIT REAR SILVER REV (EA)	\$10.00
930060	N DOUBLE GEAR VERSION 6 (4EA)	\$2.00
931050	N IDLER GEAR VERSION 5 (4EA)	\$2.00

Price and Availability Subject to Change Without Notice.
 Parts May Also be Available at Your Local Hobby Dealer.
 General Questions and Foreign Orders 847-781-9500.
 Check Here if Color Substitutions are Acceptable if Selected Color
 Choice is not Available.

Web Site: <http://www.katousa.com>

ORDERED BY : Hours: Mon-Fri 9:00 a.m. to 12:00 p.m. or 1:00 p.m. to 4:00 p.m. CST (Except Holidays)				
Name		Phone Orders 1-800-548-5286 Kato Parts Direct	Fax Orders 847-781-9570 Fax your order form	Mail Orders 100 Remington Road Schaumburg, IL 60173
Address		Phone		
City		State		
Daytime Phone Number		Area Code ()		
Zip				
SHIP TO :				
Name		Phone		
Address		City		
State		Zip		
METHOD OF PAYMENT (U.S. Funds Only)				
<input type="checkbox"/> Check <input type="checkbox"/> Money Order <input type="checkbox"/> Mastercard <input type="checkbox"/> VISA (Allow two weeks for check clearance)				
Credit Card Number		Expiration Date		
Signature				
		Shipping & Handling Charges :		SUBTOTAL
		Please add to Shipments :		IL Residents Add 8.25% Sales Tax
		\$5.00 U.S.A. Canada and Mexico. \$9.00 to Other foreign countries.		SHIPPING & HANDLING
				TOTAL DUE