

EMD E8/9 INSTRUCTIONS:

Replacing The Pilot Coupler

- 1.Pull to remove the pilot Coupler.
- 2.Remove the Coupler Pocket from the Body.
- 3.Put the Pilot Coupler Spring onto the Coupler Pocket.
- 4.Install the Coupler Pocket.
- 5.Press the Rapido-Style Coupler into the Pilot Opening.

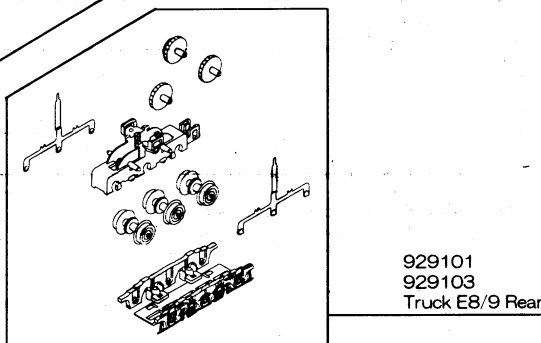
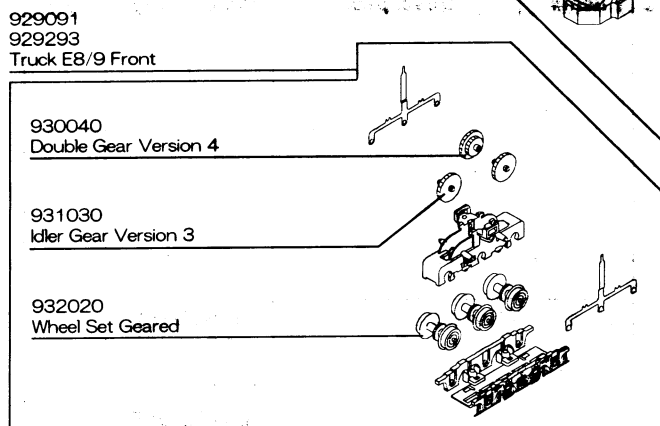
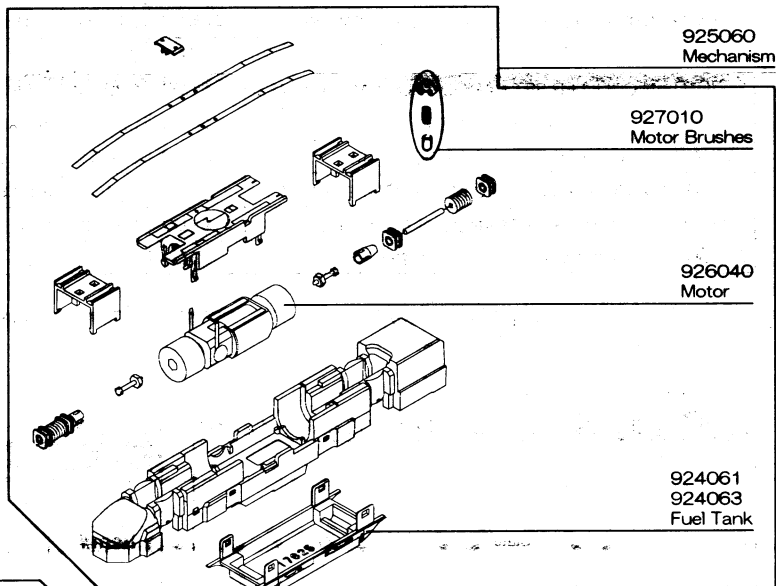
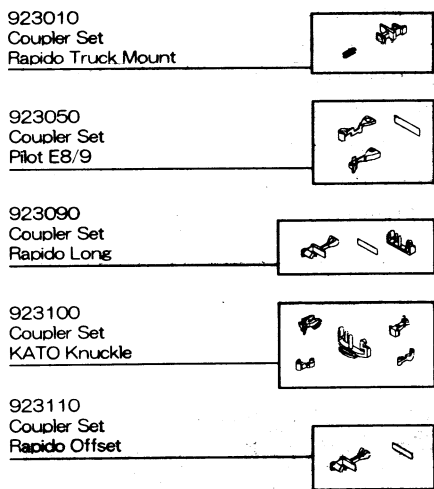
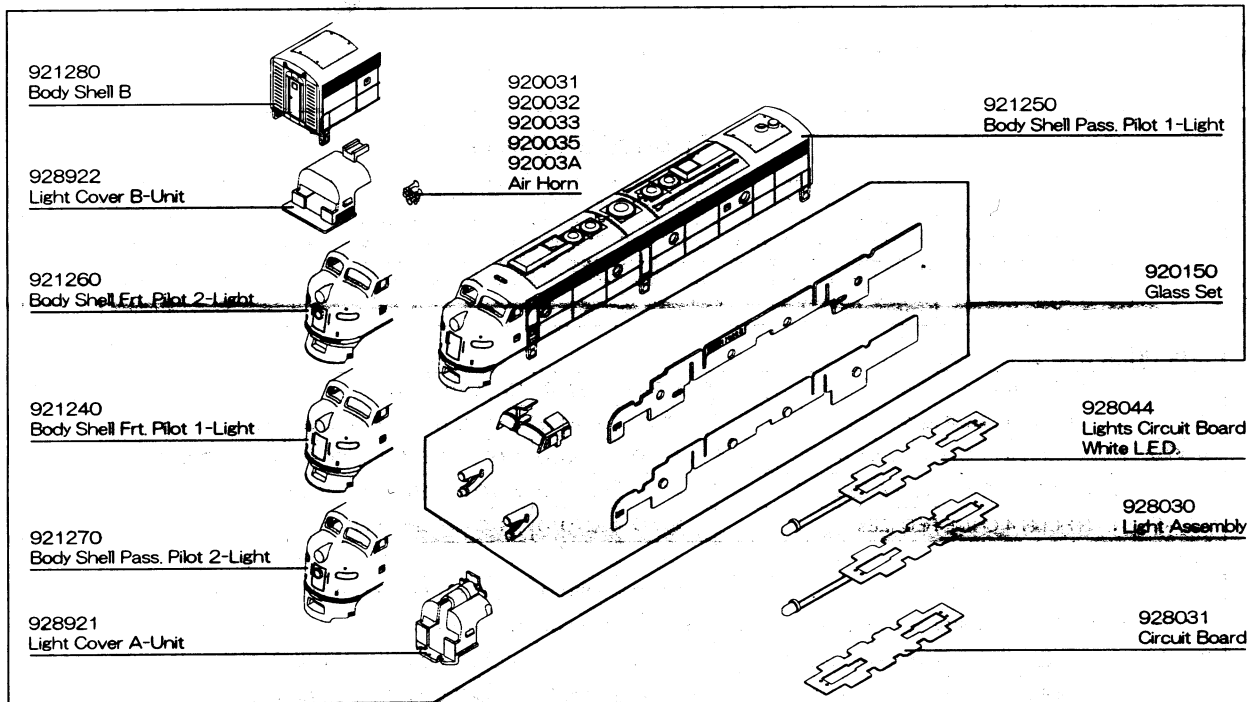
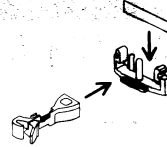

NOTICE :

- 1.Max. Operational voltage:12V DC
- 2.Additional lubrication at time of purchase is not recommended.

LIMITED WARRANTY

KATO U.S.A. INC. warrants that this product will be free from defects in material and workmanship for a period of sixty(60)days from the date of purchase. If this product fails during the warranty period, carefully pack the assembled item in the original carton, together with the dated sales receipt, and return to : KATO U.S.A. INC. 100 Remington Road, Schaumburg, IL 60173. Defects due to misuse, improper maintenance and/or abuse are not covered by this warranty. Items that have been modified by the modeler or anyone other than an authorized KATO repair person are not covered by the warranty. This warranty gives you specific legal rights and you may also have other rights which vary from state to state.

Parts Price List & Order Form

ITEM#	DESCRIPTION	RETAIL PRICE	ITEM#	DESCRIPTION	RETAIL PRICE
920031	N AIR HORN 4 CHIME BLACK (2Ea)	\$1.00	924063	N FUEL TANK E8/9 SILVER (Ea)	\$3.00
920032	N AIR HORN 4 CHIME GRAY (2Ea)	\$1.00	925060	N MECHANISM E8/9 COMPLETE w/o TRUCKS (Ea)	\$50.00
920033	N AIR HORN 4 CHIME SILVER (2Ea)	\$1.00	926040	N MOTOR E8/9 /PA/PB (Ea)	\$26.00
920035	N AIR HORN 4 CHIME RED (2Ea)	\$1.00	927010	N MOTOR BRUSHES (Ea)	\$2.00
92003A	N AIR HORN 4 CHIME TUSCAN (2Ea)	\$1.00	928030	N LIGHT ASSEMBLY E8/9A AND PA (Ea)	\$5.50
920150	N GLASS SET E8/9 (Ea)	\$4.00	928031	N CIRCUIT BOARD E8/9B AND PB (Ea)	\$5.00
921240	N BODYSHELL E8/9A SNGL HEADLIGHT FRT PILOT (Ea)	\$25.00	928044	N LIGHTS CIRCUIT BOARD WHITE L.E.D. E8/9 (Ea)	\$7.00
921250	N BODYSHELL E8/9A SNGL HEADLIGHT PASS PILOT (Ea)	\$25.00	928921	N LIGHT COVER E8/9 UNIT A (Ea)	\$1.00
921260	N BODYSHELL E8/9A DUAL HEADLIGHT FRT PILOT (Ea)	\$25.00	928922	N LIGHT COVER E8/9 UNIT B (Ea)	\$1.00
921270	N BODYSHELL E8/9A DUAL HEADLIGHT PASS PILOT (Ea)	\$25.00	929091	N TRUCK E8/9 FRONT BLACK (Ea)	\$10.00
921280	N BODYSHELL E8/9B (Ea)	\$25.00	929093	N TRUCK E8/9 FRONT SILVER (Ea)	\$10.00
923010	N COUPLER SET RAPIDO TRUCK MOUNT (4Ea)	\$1.00	929101	N TRUCK E8/9 REAR BLACK (Ea)	\$10.00
923050	N COUPLER SET PILOT E8/9 (4Ea)	\$4.25	929103	N TRUCK E8/9 REAR SILVER (Ea)	\$10.00
923090	N COUPLER SET RAPIDO LONG (4Ea)	\$4.50	930040	N DOUBLE GEAR VERSION 4 (4Ea)	\$2.00
923100	N COUPLER SET KATO KNUCKLE E8/9 /PA (4Ea)	\$2.00	931030	N IDLER GEAR VERSION 3 (4Ea)	\$2.00
923110	N COUPLER SET RAPIDO OFFSET (4Ea)	\$1.00	932020	N WHEELSET GEARED w/POINTED AXLE (6Ea)	\$9.00
924061	N FUEL TANK E8/9 BLACK (Ea)	\$3.00			

Price and Availability Subject to Change Without Notice.
 Parts May Also be Available at Your Local Hobby Dealer.
 General Questions and Foreign Orders 847-781-9500.
 Check Here if Color Substitutions are Acceptable if Selected Color
 Choice is not Available.

Web Site : <http://www.katousa.com>

ORDERED BY: _____ Hours : Mon-Fri 9 : 00 a.m. to 12 : 00 p.m. or 1 : 00 p.m. to 4 : 00 p.m. CST (Except Holidays)

Name _____			
Address _____		Phone _____	
City _____		State _____	Zip _____
Daytime Phone Number Area Code() _____			

SHIP TO :

Name _____			
Address _____		Phone _____	
City _____		State _____	Zip _____

METHOD OF PAYMENT (U.S. Funds Only)
 Check Money Order Mastercard VISA
 (Allow two weeks for check clearance)

Credit Card Number _____ Expiration Date _____
 Signature _____

Phone Orders	Fax Orders	Mail Orders
1-800-548-5286 Kato Parts Direct	847-781-9570 Fax your order form	100 Remington Road Schaumburg, IL 60173

Item#	Description	Price	Qty.	Total

Shipping & Handling Charges:

Please add to Shipments :
 \$5.00 U.S.A. Canada and Mexico.
 \$9.00 to Other foreign countries.

SUBTOTAL

IL Residents
 Add 8.25% Sales Tax

SHIPPING & HANDLING

TOTAL DUE